



OMEGA SD10 SK DUO Vapour Barrier

Weather-resistant 3-layer roof sheeting with vapour delaying effect for all insulation on battens. 2 two-way acrylate adhesive strips are integrated for adhesion at joints.

FIELDS OF APPLICATION

- for over-rafter insulation
- on the room side below the thermal insulation

ADVANTAGES

- lightweight
- tear-resistant
- rigid
- 100% recyclable
- resistant to ageing
- max. 2 months exposure to the elements

RECOMMENDED ACCESSORIES



OMEGA QUILLI



OMEGA Nail-Seal Tape



PE Nail-Seal Tape DSK









AIRSTOP Sealant SPRINT

AVAILABLE IN THE FOLLOWING DIMENSIONS

Roll width	1,5 m
Roll length	50 m
Roll area	75 m ²
Roll weight	13,5 kg

PRODUCT DATA ACCORDING TO STANDARD EN 13984

Material composition	3-layer PP fleece with two two-way acrylate adhesive strips
Thickness	ca. 0,75 mm
Colour	beige
Weight per unit area	175 g / m ²
Sd - value	10 m (-4 / +8)
Temperature resistance	- 40 °C - + 80 °C (short-term 100°C)
UV - resistance	2 months
Resistance to water penetration EN 1928	W1
Elongation EN 12311-1	 55 (-20/+40) %  65 (-20/+40) %
Tensile strength EN 12311-1	 255 (-55/+95) N/ 50 mm  190 (-30/+75) N/ 50 mm
Tear propagation resistance EN 12310-1	 195 (-40/+105) N  255 (-35/+70) N
Storage	cool and dry
Fire performance EN 13501-1/EN 11925-2	E

11.2017_EN

ISOCELL

GUIDELINES FOR THE USE OF **OMEGA** SD10 VAPOUR BARRIER

APPLICATION

Installation: position on the sheathing with the printed side facing upwards (UV-resistant side). Attach to the wooden subframe using a tackler.

Overlaps and edge joints: min. 10 cm overlap — this is marked on the OMEGASD10 SK DUO Vapour Barrier with green dotted lines.

Using sufficient pressure press together the acrylate strip of one length and the appropriate two-way adhesive strip of the other length. AIRSTOP Sealant SPRINT or OMEGA QUILLI should be used for an airtight seal at joints.

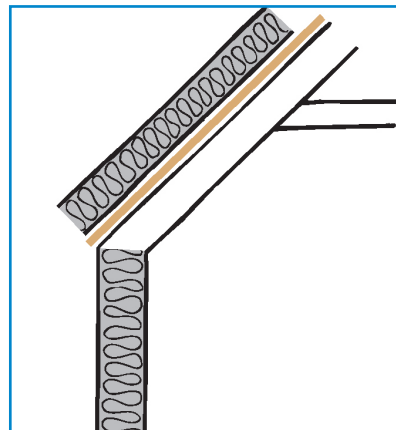

ISOCELL GmbH
Gewerbestraße 9
5202 NEUMARKT AM WALLERSEE | Österreich
Tel.: +43 6216 4108 | Fax: +43 6216 7979
office@isocell.at

ISOCELL SCHWEIZ AG
Herbergstrasse 29
9524 ZUZWIL | Suisse /Schweiz
Tel.: +41 71 544 47 20
office@isocell.ch

ISOCELL FRANCE
170 Rue Jean Monnet | ZAC de Prat Pip Sud
29490 GUIPAVAS | France
Tél.: +33 2 98 42 11 00 | Fax: +33 2 98 42 11 99
contact@isocell-france.fr

ISOCELL BUREEL BELGIË
Außenborner Weg 1 | Schoppen
4770 AMEL | Belgique
Tél.: +32 80 39 90 58 | Fax: +32 80 39 97 68
office@isocell.be

ISOCELL Sverige AB
Gamla Stallet | Stora Väsby
194 37 UPPLANDS VÄSBY | Sverige
Tel.: +46 10 130 25 01
office@isocell.se

ISOCELL
www.isocell.com