



# OMEGA SD10 Vapour Barrier

Weather-resistant 3-layer roof sheeting with vapour delaying effect for all insulation on battens.

## FIELDS OF APPLICATION

- for over-rafter insulation
- on the room side below the thermal insulation

## ADVANTAGES

- lightweight
- tear-resistant
- rigid
- 100% recyclable
- resistant to ageing
- max. 2 months exposure to the elements

## RECOMMENDED ACCESSORIES



**OMEGA** QUILLI



**OMEGA** Nail-Seal Tape



PE Nail-Seal Tape DSK



**AIRSTOP** Sealant SPRINT

## AVAILABLE IN THE FOLLOWING DIMENSIONS

Roll width	3,0 m
Roll length	50 m
Roll area	150 m <sup>2</sup>
Roll weight	27 kg

## PRODUCT DATA ACCORDING TO STANDARD EN 13984

Material composition	3-layer PP fleece
Thickness	ca. 0,75 mm
Colour	beige
Weight per unit area	175 g / m <sup>2</sup>
Sd - value	10 m (-4 / +8)
Temperature resistance	- 40 °C - + 80 °C (short-term 100°C)
UV - resistance	2 months
Resistance to water penetration EN 1928	W1
Elongation EN 12311-1	55 (-20/+40) %  65 (-20/+40) %
Tensile strength EN 12311-1	255 (-55/+95) N/ 50 mm 190 (-30/+75) N/ 50 mm
Tear propagation resistance EN 12310-1	195 (-40/+105) N  255 (-35/+70) N
Storage	cool and dry
Fire performance EN 13501-1/EN 11925-2	E

12.2017\_EN

# ISOCELL

# GUIDELINES FOR THE USE OF **OMEGA** VAPOUR BARRIER

## APPLICATION

Installation: position on the sheathing with the printed side facing upwards (UV-resistant side). Attach to the wooden subframe using a tackler.

Overlaps and edge joints: min. 10 cm overlap — this is marked on the OMEGA Vapour Barrier with green dotted lines. Overlaps and joints should be sealed airtight with AIRSTOP Sealant SPRINT or with OMEGA QUILLI

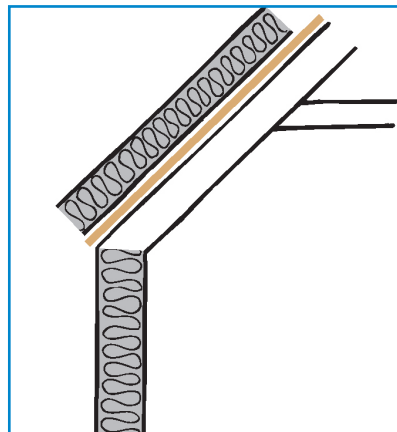

ISOCELL GmbH  
Gewerbestraße 9  
5202 NEUMARKT AM WALLERSEE | Österreich  
Tel.: +43 6216 4108 | Fax: +43 6216 7979  
office@isocell.at

ISOCELL SCHWEIZ AG  
Herbergstrasse 29  
9524 ZUZWIL | Suisse /Schweiz  
Tel.: +41 71 544 47 20  
office@isocell.ch

ISOCELL FRANCE  
170 Rue Jean Monnet | ZAC de Prat Pip Sud  
29490 GUIPAVAS | France  
Tél.: +33 2 98 42 11 00 | Fax: +33 2 98 42 11 99  
contact@isocell-france.fr

ISOCELL BUREEL BELGIË  
Außenborner Weg 1 | Schoppen  
4770 AMEL | Belgique  
Tel.: +32 80 39 90 58 | Fax: +32 80 39 97 68  
office@isocell.be

ISOCELL Sverige AB  
Gamla Stallet | Stora Väsbys  
194 37 UPPLANDS VÄSBY | Sverige  
Tel.: +46 10 130 25 01  
office@isocell.se

**ISOCELL**  
[www.isocell.com](http://www.isocell.com)